



**Restaurant  
& Retail  
Available!**

# New Development

## Stockdale Plaza in Bakersfield

For Lease

1,345 SF Restaurant/Retail

5601 California Avenue





## Property Highlights

- 1,345 SF in new restaurant/retail pad building development available for lease
- Situated within Stockdale Plaza, anchored by Bed Bath & Beyond, Smart & Final Extra, CVS & ALDI Market
- Traffic Counts:  
 Stockdale Hwy @ California Ave: 42,773 CPD  
 California Ave @ Stockdale Hwy: 37,998 CPD



## Co-Tenants



## Area Retailers



**Matt Haas**  
 805.449.1804 ext. 106  
 mhaas@cypress.net  
 License No. 01970296

**Bob Haas**  
 805.449.1804 ext. 103  
 rhaas@cypress.net  
 License No. 00870324

# Trade Area Demographics

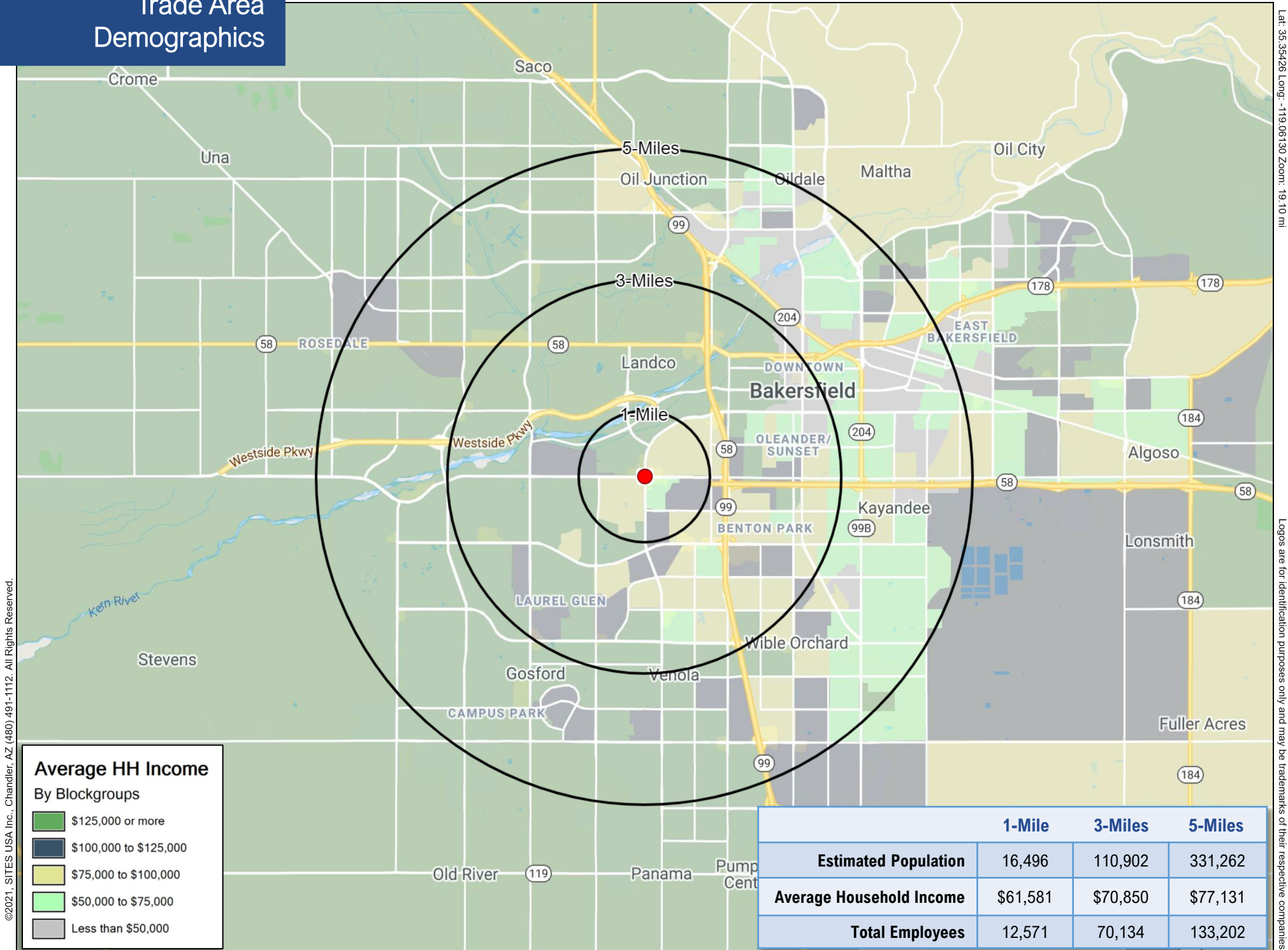

©2021, SITES USA Inc., Chandler, AZ (480) 491-1112. All Rights Reserved.

This map was produced using data from private and government sources deemed to be reliable. The information herein is provided without representation or warranty.

Lat: 35.35426 Long: -119.06130 Zoom: 19.10 mi

Logos are for identification purposes only and may be trademarks of their respective companies.

California Ave: 37,998 CPD

Stockdale Hwy: 42,773 CPD

Business Center Dr

# STOCKDALE PLAZA

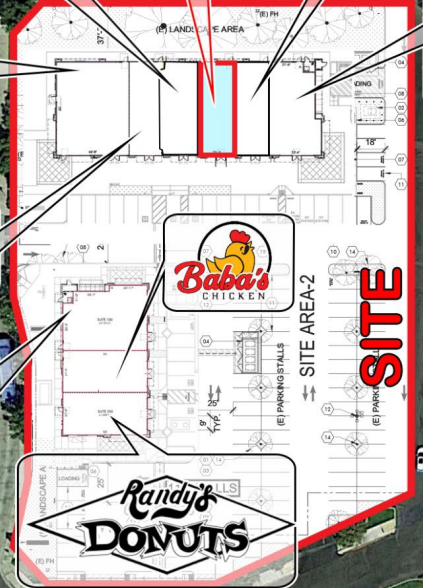

**CHUZE FITNESS**  
COMING SOON



**BED BATH & BEYOND**



**CVS**





**ROSEDALE VILLAGE**  
 STUDIO MOVIE GRILL | Smart&Final | TRACTOR SUPPLY CO | DOLLAR TREE



**ROSEDALE PLACE**  
 HARBOR FREIGHT | QUALITY TOOLS | LOWEST PRICES



**NORTHWEST PROMENADE**  
 Target | Walmart | BEST BUY | ROSS DRESS FOR LESS | KOHL'S | Office DEPOT | Michaels | THE HOME DEPOT | WORLD MARKET | petco | FAMOUS footwear

**BAKERSFIELD PLAZA**  
 HOBBY LOBBY | Burlington | AMC | ROSS DRESS FOR LESS | LASSENS

Westside Pkwy

California Ave

California Ave

**STOCKDALE VILLAGE**  
 HomeGoods | Party City | VONS | Office DEPOT | DOLLAR TREE

**STOCKDALE PLAZA**  
 BED BATH & BEYOND | ALDI | Smart&Final extra | CVS | IN-N-OUT BURGER | Chick-fil-z

**TOWN & COUNTRY VILLAGE**  
 Albertsons | TRADER JOE'S | CVS

Stockdale Hwy

**PET SMART** | food maxx | Walgreens | 99¢ only

**VALLEY VILLAGE**  
 Marshalls | Michaels

**SHOPS AT RIVER WALK**  
 rack | TJ-maxx | TARGET | SPROUTS FARMERS MARKET

Ming Ave

**THE MARKETPLACE**  
 RITE AID | EDWARDS THEATRES | VONS | WILLIAMS SONOMA



Buena Vista Rd

Albertsons | RITE AID



White Ln

VONS | CVS

AMERICAN FREIGHT FURNITURE - MATTRESS | SUPERIOR GROCERS

DOLLAR TREE | VALLEARITA

White Ln

**GOSFORD VILLAGE**  
 KOHL'S | Walmart | Walgreens | petco | Sam's CLUB



Gosford Rd

WinCo FOODS



Panama Ln



Walmart | Lowe's

THE GROVE | VALLEARITA

Walgreens

CARMAX



TEASPOON

1,345 SF Available

Pizza Guys

BUSINESS CENTER DRIVE

California FISH GRILL CASUAL KITCHEN

Waba grill

RED WING SHOES

Urbane Cafe

Baba's CHICKEN

CHUZE FITNESS COMING SOON



Randy's DONUTS

CALIFORNIA AVENUE

SITE AREA-1

296 STALLS

NOT A PART

theVitamin Shoppe

Chick-fil-A

CVS pharmacy

STOCKDALE HIGHWAY

(E) SIGNALIZED INTERSECTION

(E) BASE/MEDIAN

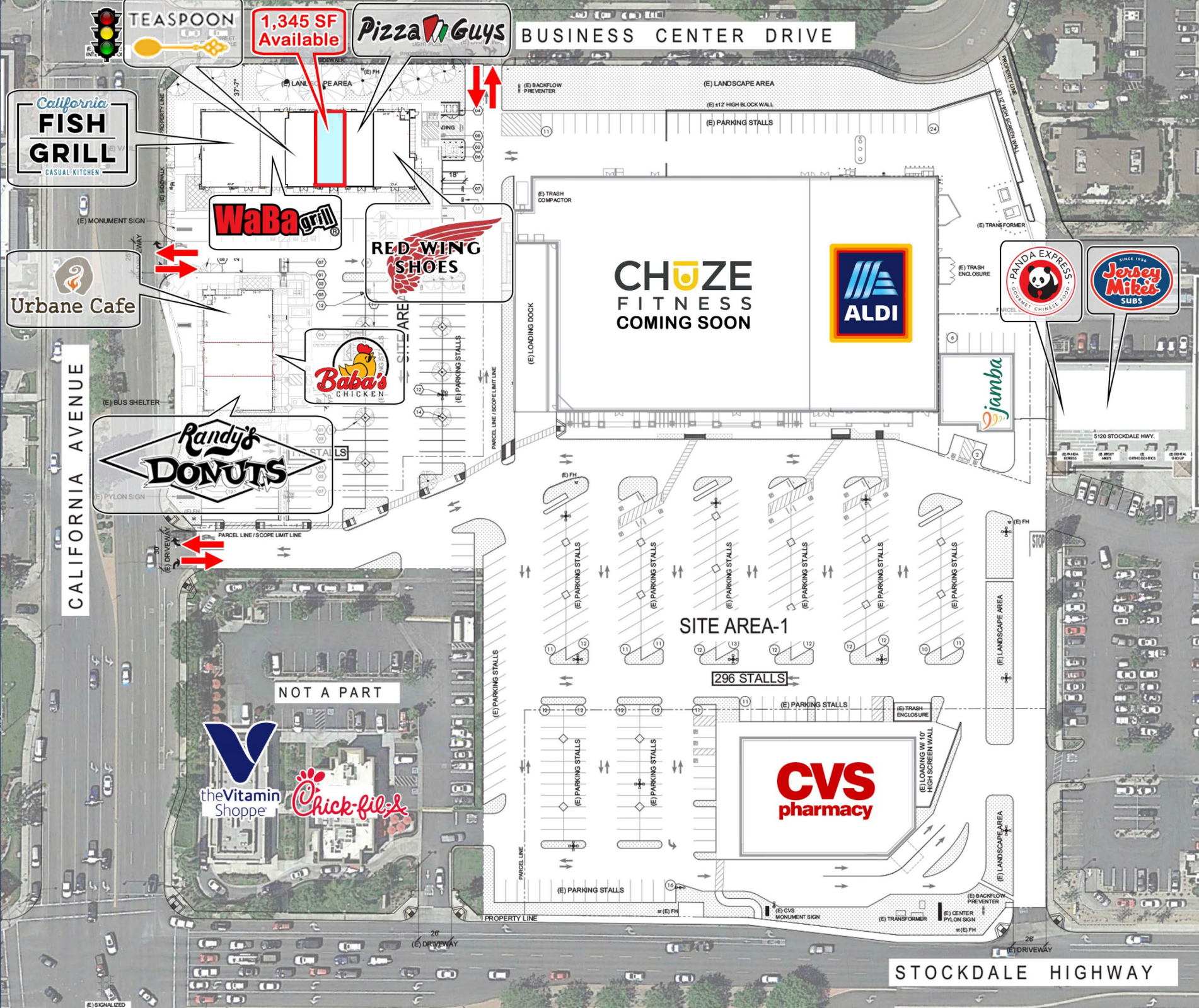

# Building 2 Proposed Floor Plan

1,345 SF Available

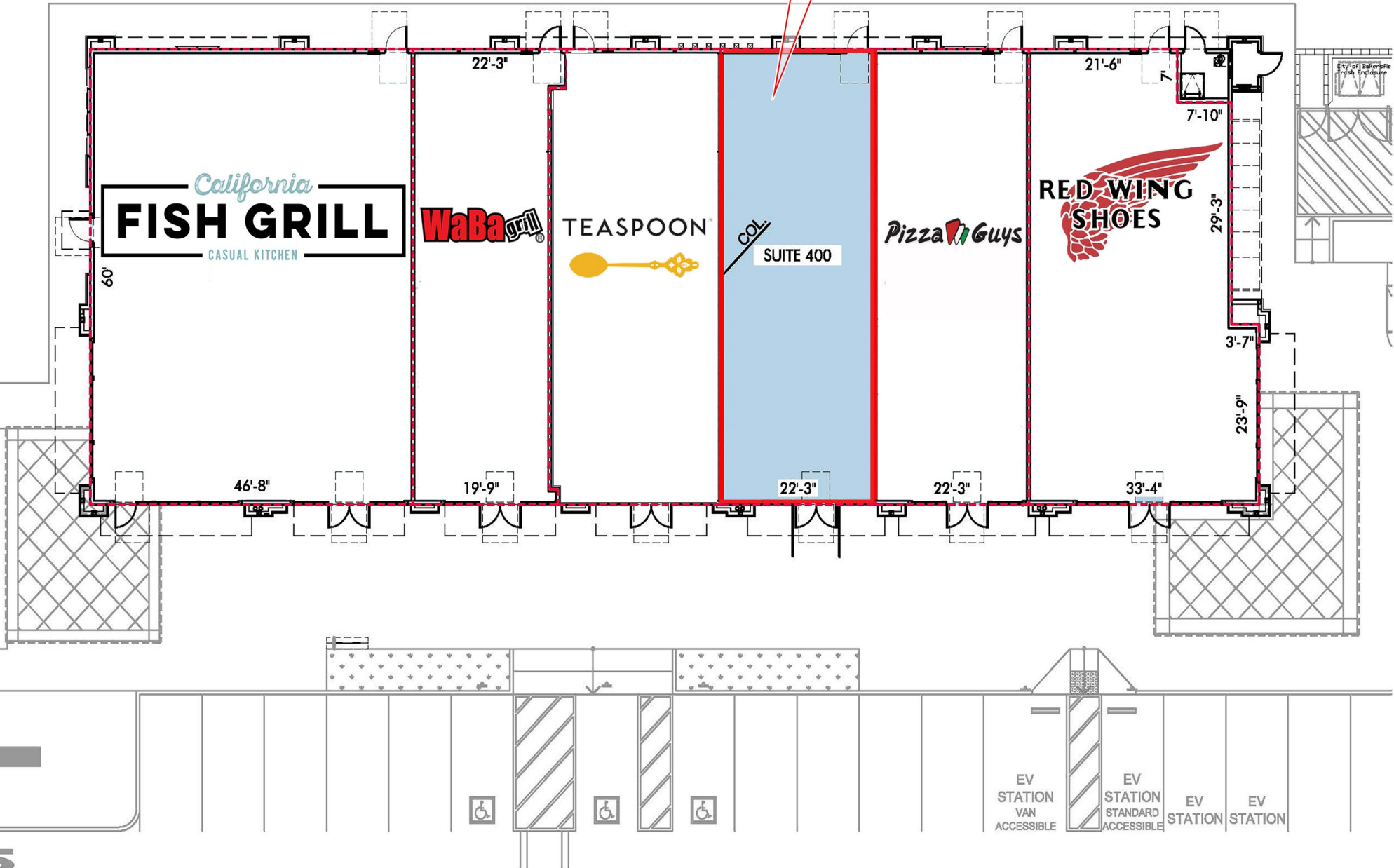



## Contact Us

### Matt Haas

805.449.1804 ext. 106

mhaas@cypress.net

License No. 01970296

### Bob Haas

805.449.1804 ext. 103

rhaas@cypress.net

License No. 00870324



[www.cypress.net](http://www.cypress.net)

**North Office**  
3625 E Thousand Oaks Blvd, Suite 108  
Westlake Village, CA 91362

The information provided herein is intended as a general depiction of the property and is subject to change. This information has been obtained by sources deemed reliable. The information has not been independently verified and Cypress Retail Group and its agents do not warrant or represent that the information provided is accurate. Individuals are solely responsible for verifying information related to the property and its suitability for the individual's use.