



**Jr. Anchor  
Opportunity  
Available!**

# SWC Victory Blvd & Canoga Ave

## Woodland Hills

**FOR LEASE** 7,725 SF Jr. Anchor Opportunity in "A" Trade Area & Center





## Property Highlights

- 7,725 SF Jr. Anchor Opportunity
- "A" trade area & center
- 200,000 SF Shopping Center anchored by Nordstrom Rack and Bloomingdale's The Outlet Store
- Across the street from the Westfield Topanga Mall, Village at Topanga and Costco
- Ample surface parking
- Traffic Counts:
  - Victory Blvd @ Canoga Ave: 33,165 CPD
  - Canoga Ave @ Victory Blvd: 29,236 CPD

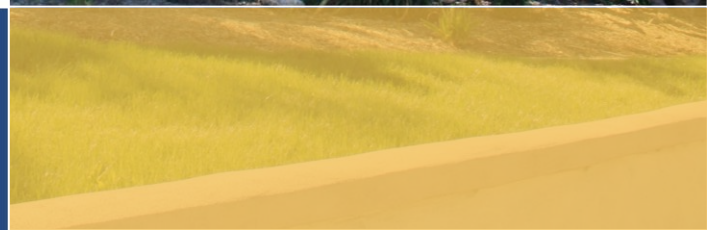

## Co-Tenants



## Area Retailers



**Matt Haas**  
 805.449.1804 ext. 106  
 mhaas@cypress.net  
 License No. 01970296

**Bob Haas**  
 805.449.1804 ext. 103  
 rhaas@cypress.net  
 License No. 00870324

# Trade Area Demographics

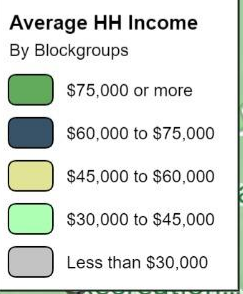
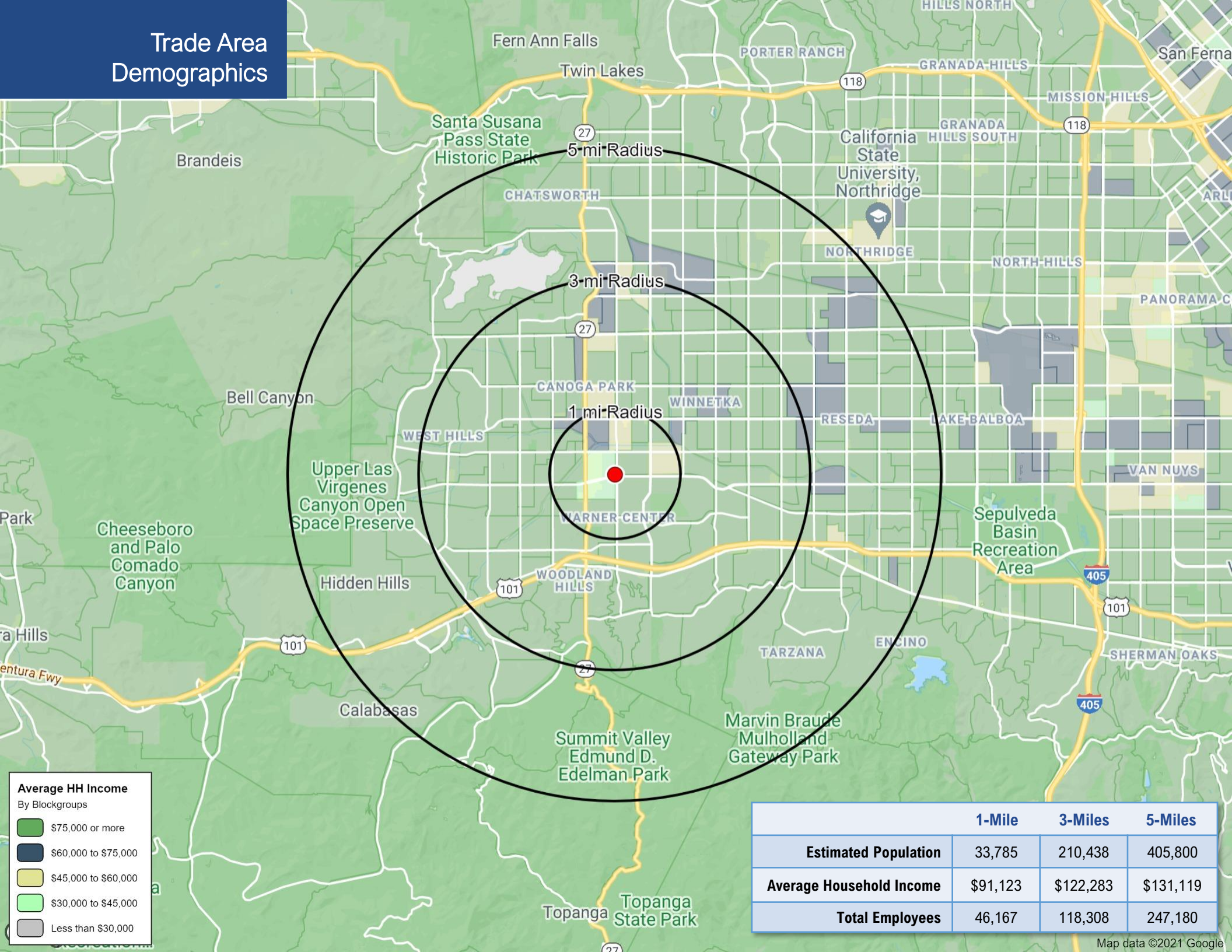

	1-Mile	3-Miles	5-Miles
<b>Estimated Population</b>	33,785	210,438	405,800
<b>Average Household Income</b>	\$91,123	\$122,283	\$131,119
<b>Total Employees</b>	46,167	118,308	247,180

Aerial

WARNER  
CENTER  
OFFICE

LA FITNESS  
NORDSTROM  
rack  
Saks OFF 5TH  
blomingdales  
the outlet store

Office  
DEPOT

amazon  
fresh

Westfield  
Village at Topanga

Crate &  
Barrel

COSTCO  
WHOLESALE

Westfield  
Topanga

BEST  
BUY  
ROGER DUNN  
GOLF SHOPS

BJ's

CANOGA AVE 35,683 CPD

VICTORY BLVD 34,871 CPD

N.A.P.

Rocketdyne Site  
Proposed Development  
3,950 Residential Units  
210 Hotel Rooms  
1.5 Million SF Office/Retail

ULTA  
BEAUTY

# Site Plan

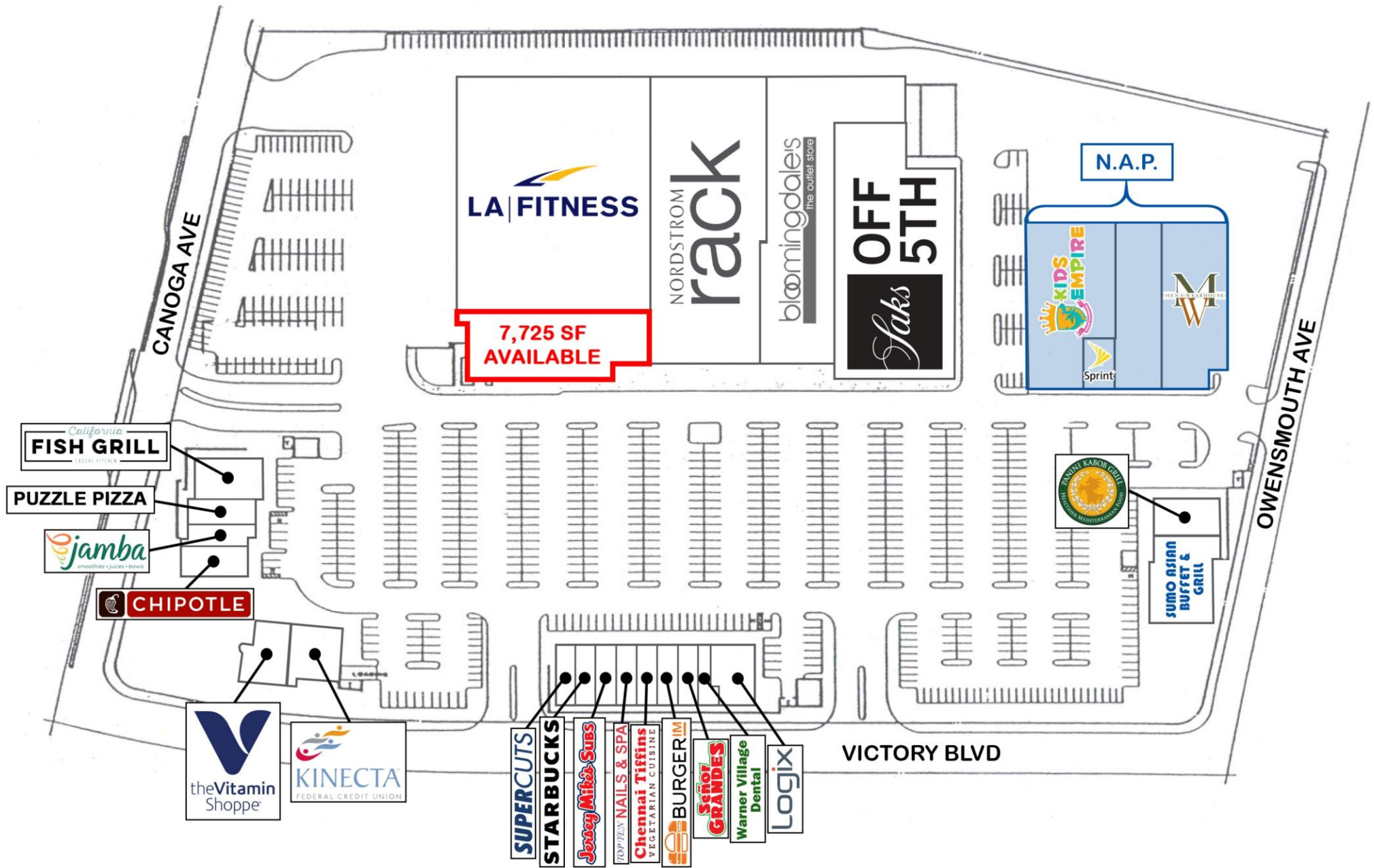

# Existing Floor Plan

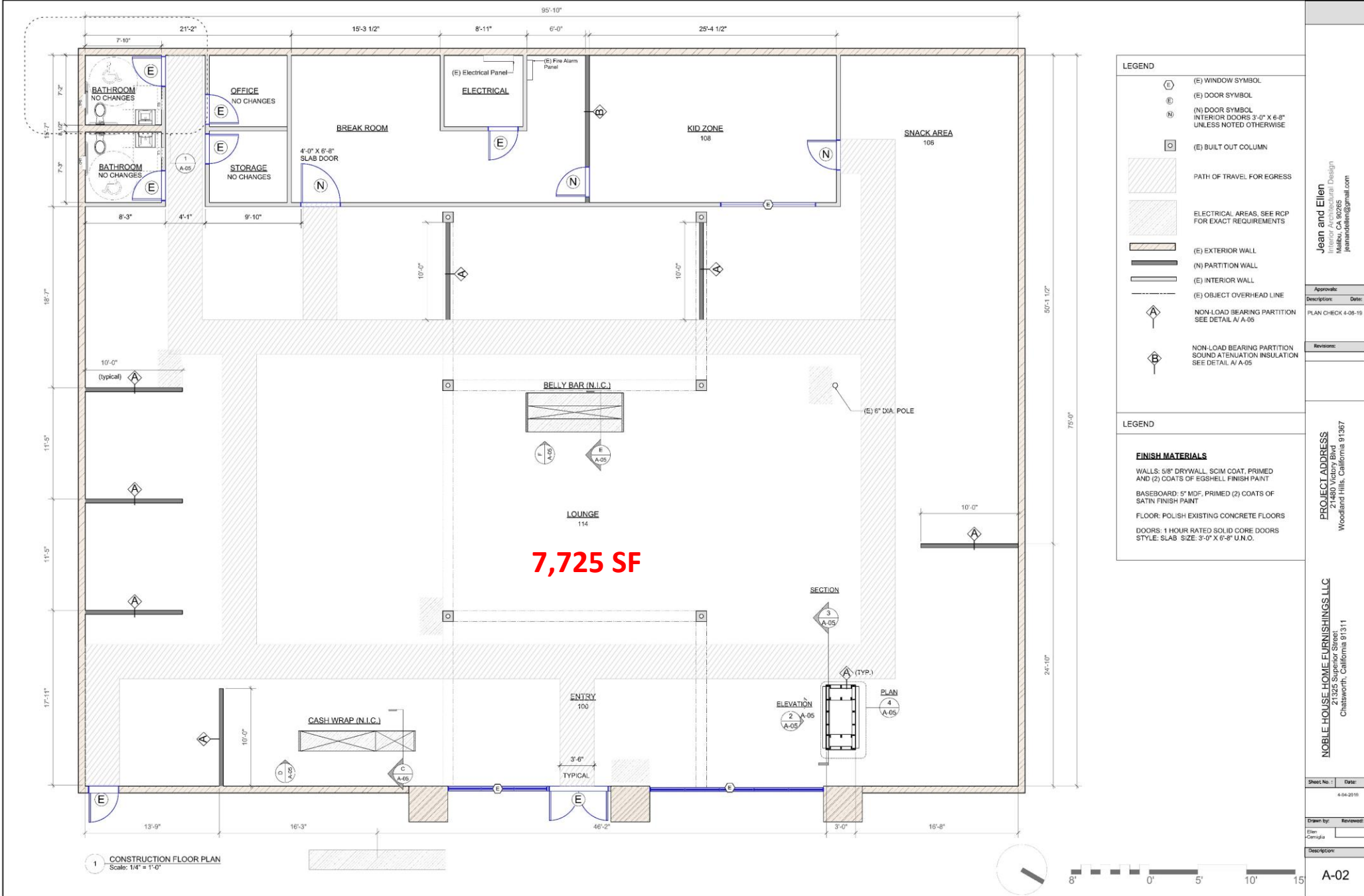



## Contact Us

### Matt Haas

805.449.1804 ext. 106  
mhaas@cypress.net  
License No. 01970296

### Bob Haas

805.449.1804 ext. 103  
rhaas@cypress.net  
License No. 00870324

The information provided herein is intended as a general depiction of the property and is subject to change. This information has been obtained by sources deemed reliable. The information has not been independently verified and Cypress Retail Group and its agents do not warrant or represent that the information provided is accurate. Individuals are solely responsible for verifying information related to the property and its suitability for the individual's use.

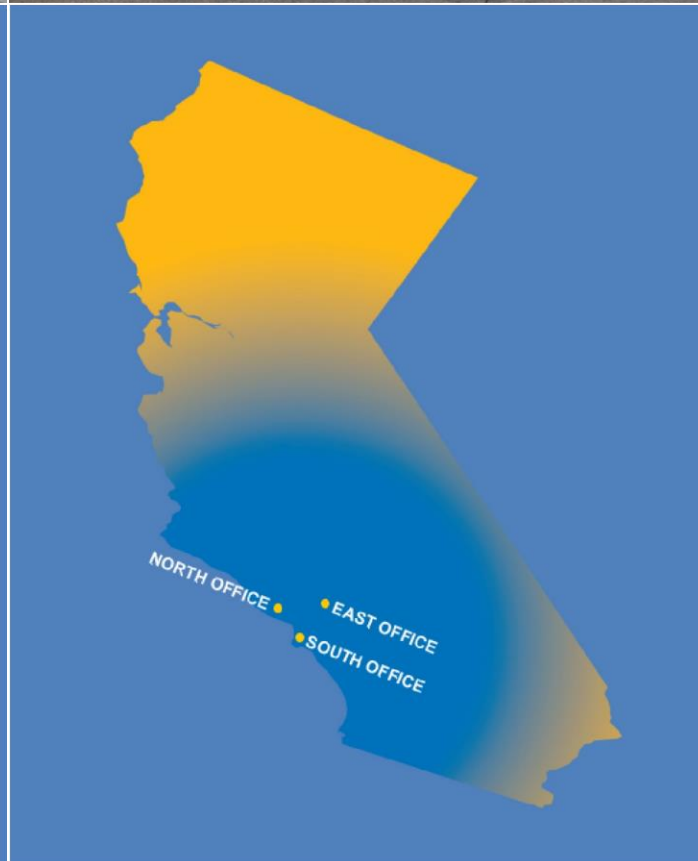

[www.cypress.net](http://www.cypress.net)

North Office  
3625 E Thousand Oaks Blvd, Suite 108  
Westlake Village, CA 91362