

# College Block Shopping Center

Northridge, CA

FOR LEASE

Ground Lease Opportunity, Approx. 1 Acre Lot | NEC Reseda & Vincennes



For Leasing Information, Contact:

**Matt Haas**

805.449.1804 ext. 106  
mhaas@cypress.net  
License No. 01970296

**Bob Haas**

805.449.1804 ext. 103  
rhaas@cypress.net  
License No. 00870324



# PROPERTY HIGHLIGHTS

- Ground lease opportunity on approx. 1 acre of land at the NEC of the signalized Reseda Blvd/Vincennes St intersection
- One block west of approx. 39,816 students and more than 4,000 employees at California State University Northridge (CSUN)
- College Block Shopping Center co-tenants and areawide tenants include Starbucks, Vons, Chipotle, Dave’s Hot Chicken, The Habit, Rite Aid, Dunkin’ Donuts, My Gym, and NY Pizza Factory

| Demographics             | 1-Mile    | 3-Miles   | 5-Miles   |
|--------------------------|-----------|-----------|-----------|
| Estimated Population     | 23,078    | 192,810   | 567,212   |
| Average Household Income | \$100,007 | \$112,460 | \$107,183 |
| Daytime Population       | 8,204     | 83,846    | 217,075   |



## Surrounding Retailers



**Matt Haas**  
 805.449.1804 ext. 106  
 mhaas@cypress.net  
 License No. 01970296

**Bob Haas**  
 805.449.1804 ext. 103  
 rhaas@cypress.net  
 License No. 00870324



PLUMMER ST



CSUN  
Parking  
Structure

VINCENNES ST



DARBY AVE

CSUN  
Transit  
Center



California State University  
**Northridge**  
39,816 Students

PRAIRIE ST

YOLANDA AVE



chil's

DEARBORN ST

SUBWAY

Auto  
Zone

BIG 5  
SPORTING GOODS

CALIF.  
CHICKEN CAFE



YOSHINOYA

metro PCS BOBA

T-Mobile Great Clips



BAJA FRESH

Maria's  
ITALIAN KITCHEN



VONS



38,436 CPD

NORDHOFF ST

45,490 CPD



WELLS  
FARGO

SHARKY'S  
WOODFIRED MEXICAN GRILL



FarmerBoys



Urbane Cafe

FLAME BROILOER  
SIMPLY HEALTHY



ETIWANDA AVE

LINDLY AVE

# Former Tenant's Site Plan

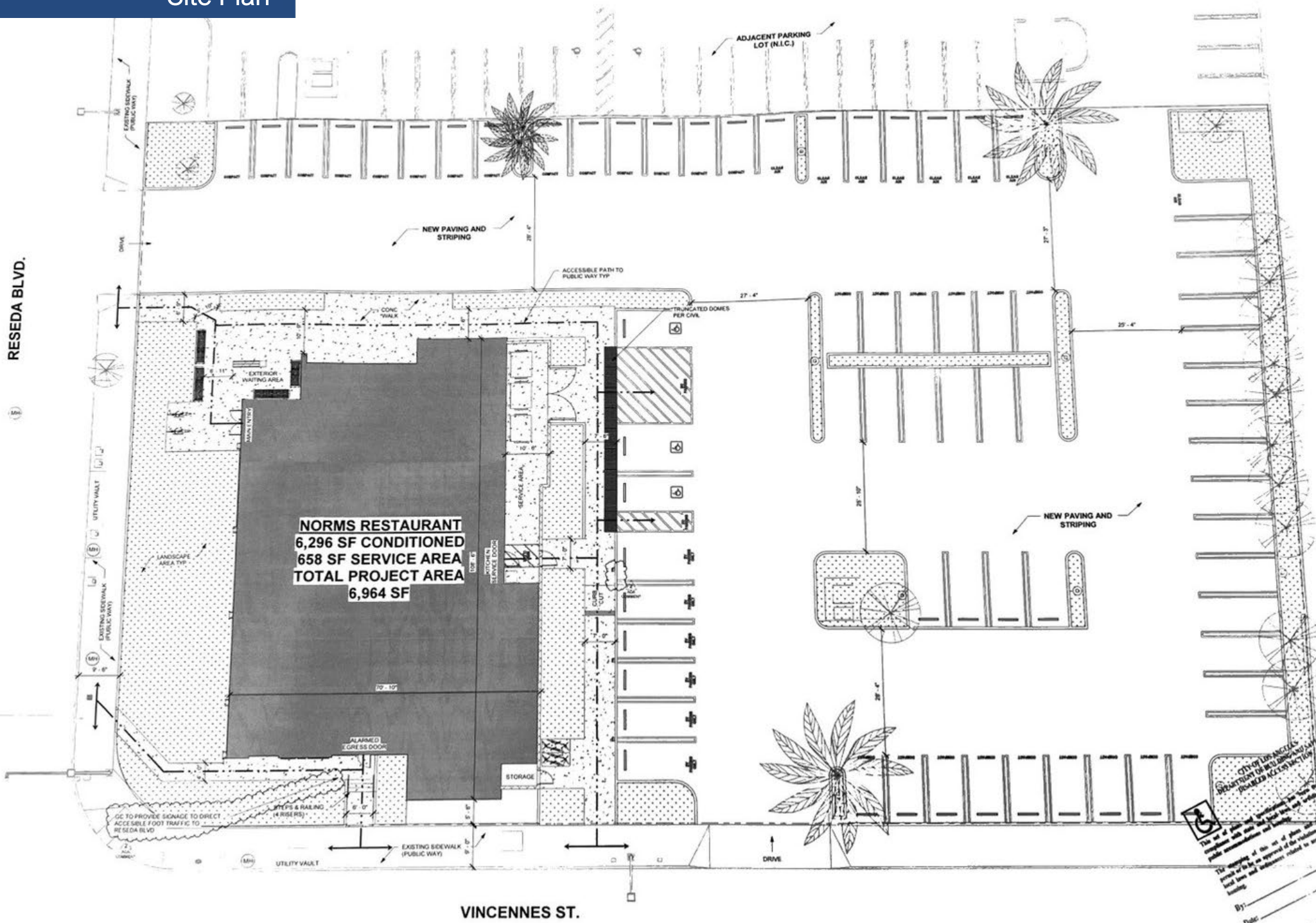

**NORMS RESTAURANT**  
**6,296 SF CONDITIONED**  
**658 SF SERVICE AREA**  
**TOTAL PROJECT AREA**  
**6,964 SF**

VINCENNES ST.

RESEDA BLVD.

CITY OF LOS ANGELES  
 DEPARTMENT OF PUBLIC WORKS  
 PLANNED ACCESSIBILITY

The use of this plan and any information derived therefrom is subject to the terms and conditions of the standard license agreement for the City of Los Angeles. The Department of Public Works is not responsible for any errors or omissions in this plan and any information derived therefrom.

The signature of the set of plans  
 shall be a condition of the issuance of  
 a permit and shall be subject to the  
 terms and conditions of the standard  
 license agreement.

By: \_\_\_\_\_  
 Date: \_\_\_\_\_



CYPRESS RETAIL GROUP

## Contact Us

### **Matt Haas**

805.449.1804 ext. 106  
mhaas@cypress.net  
License No. 01970296

### **Bob Haas**

805.449.1804 ext. 103  
rhaas@cypress.net  
License No. 00870324

### **North Office**

3625 E Thousand Oaks Blvd., Suite 108  
Westlake Village, CA 91362

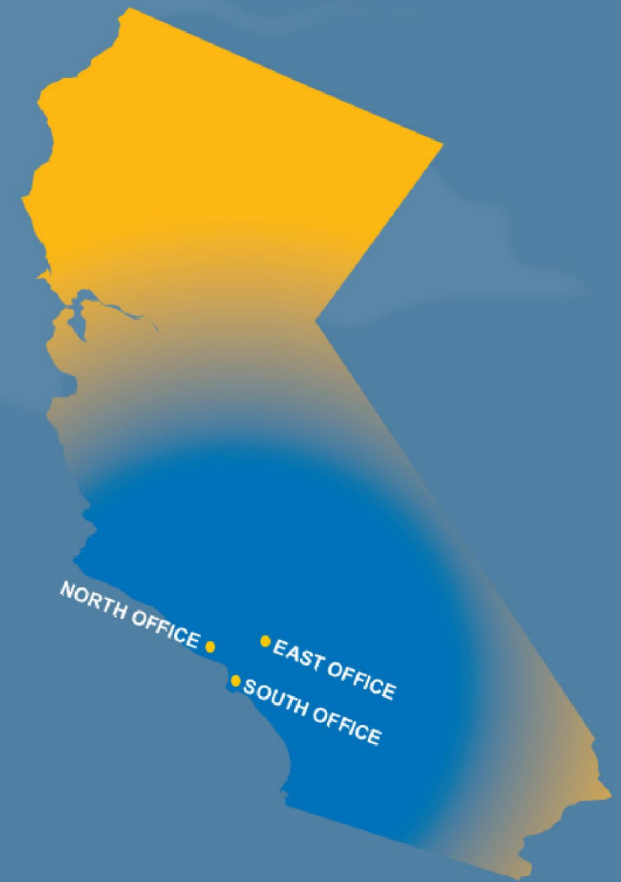

[www.cypress.net](http://www.cypress.net)

The information provided herein is intended as a general depiction of the property and is subject to change. This information has been obtained by sources deemed reliable. The information has not been independently verified and Cypress Retail Group and its agents do not warrant or represent that the information provided is accurate. Individuals are solely responsible for verifying information related to the property and its suitability for the individual's use.